

D TYPE CONNECTORS - TURNED PIN

SOLDER BUCKET

- 9, 15, 25, 37 or 50 way
- Turned Pin (Machined) Contact
- Gold Plated Contacts
- Yellow Zinc Metal or Tin Housings available
- Current Rating - 5 Amps

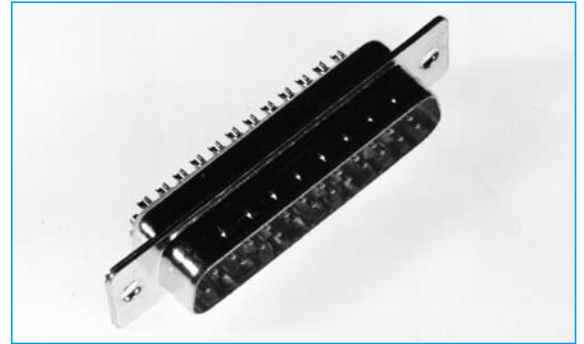

SPECIFICATION

Mechanical:

Termination: Hand Solder
 Dip Solder straight
 Dip Solder 90°C
 Wire Wrap 0.6 x 0.6mm

Polarisation: by trapezoidal shell

Coupling: by friction, locking by special accessories

Withdrawal force: ca. 0.5 N per contact

Material and Finishes: Shell steel with yellow passivation over zinc plate (standard), steel nickel plated and tinned

Insulators: Two part mouldings, polyester, glass fibre re-enforced, flame retarded according UL 94 V0

Contacts: gold plated over nickel

Insertion Cycles: 500

Electrical:

Creeping Current Stability: KB 220 according to DIN 53480

Working Current: 5A per contact with 20AWG cable

Working Voltages: 300V rms

Test Voltage: 1000V rms

Contact Resistance: below $5 \times 10^{-3} \Omega$

Insulation Resistance: over 10M Ω

Temperature Range: - 55°C to 125°C

SECTION 11

OUTLINE DRAWING

PANEL CUT OUT

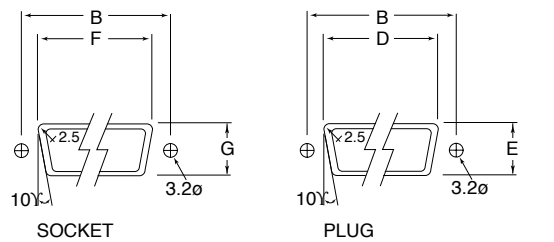

	A	B	C	D	E	F	G
9 WAY	30.8	25.0	12.4	22.2	13.0	20.5	11.4
15 WAY	39.2	33.3	12.4	30.5	13.0	28.8	11.4
25 WAY	53.1	47.0	12.4	44.3	13.0	42.5	11.4
37 WAY	69.5	63.5	12.4	60.7	13.0	59.1	11.4
50 WAY	67	61.1	15.4	58.3	13.0	56.3	14.1

Dimension - mm

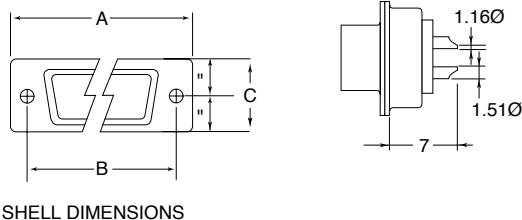

ORDERING INFORMATION

DBC	TD	M1	SB	09	3
Dubilier Connectors	Series	Connector Type	Contact Style	N° of Ways	
	TD = Turn Pin D	M1 = Male(plug) zinc F1 = Female(socket) zinc M2 = Male (plug) Tin F2 = Female (Socket) Tin	SB = Solder Bucket	09 = 9ways 15 = 15ways 25 = 25ways 37 = 37ways 50 = 50ways	

D TYPE CONNECTORS - TURNED PIN

PCB STRAIGHT PIN

- 9, 15, 25, 37 or 50 way
- Turned Pin (Machined) Contact
- Gold Plated Contacts
- Yellow Zinc Metal or Tin Housings available
- Current Rating - 5Amps

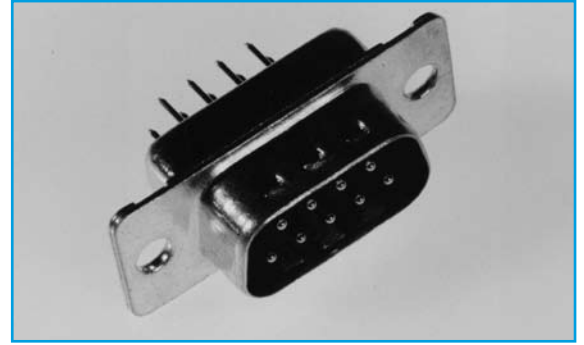

SPECIFICATION

Mechanical:

Termination: Hand Solder
 Dip Solder straight
 Dip Solder 90°C
 Wire Wrap 0.6 x 0.6mm

Polarisation: by trapezoidal shell

Coupling: by friction, locking by special accessories

Withdrawal force: ca. 0.5 N per contact

Material and Finishes: Shell steel with yellow passivation over zinc plate (standard), steel nickel plated and tinned

Insulators: Two part mouldings, polyester, glass fibre re-enforced, flame retarded according UL 94 V0

Contacts: gold plated over nickel

Insertion Cycles: 500

Electrical:

Creeping Current Stability: KB 220 according to DIN 53480

Working Current: 5A per contact with 20AWG cable

Working Voltages: 300V rms

Test Voltage: 1000V rms

Contact Resistance: below $5 \times 10^{-3} \Omega$

Insulation Resistance: over 10M Ω

Temperature Range: -55°C to 125°C

SECTION 11

OUTLINE DRAWING

PANEL CUT OUT

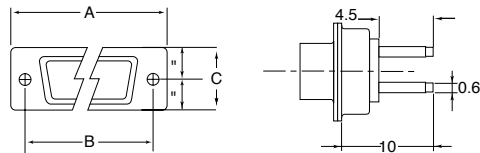
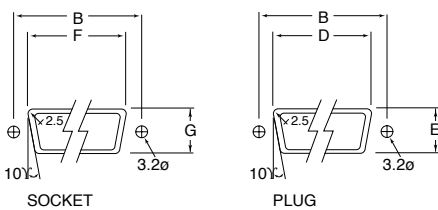

SHELL DIMENSIONS

	A	B	C	D	E	F	G
9 WAY	30.8	25.0	12.4	22.2	13.0	20.5	11.4
15 WAY	39.2	33.3	12.4	30.5	13.0	28.8	11.4
25 WAY	53.1	47.0	12.4	44.3	13.0	42.5	11.4
37 WAY	69.5	63.5	12.4	60.7	13.0	59.1	11.4
50 WAY	67	61.1	15.4	58.3	13.0	56.3	14.1

Dimension - mm

ORDERING INFORMATION

DBC	TD	M1	SS	09	3
Dubilier Connectors	Series	Connector Type	Contact Style	N° of Ways	
	TD = Turn Pin D	M1=Male(plug) zinc F 1= Female(socket) zinc M2 = Male (plug) Tin F2 = Female (socket) Tin	SS = Solder Straight	09 = 9ways 15 = 15ways 25 = 25ways 37 = 37ways 50 = 50ways	

D TYPE CONNECTORS - TURNED PIN

- 9, 15, 25, 37 or 50 way
- Turned Pin (Machined) Contact
- Gold Plated Contacts
- Yellow Zinc Metal or Tin Housings available
- Current Rating - 5Amps

PCB - RIGHT ANGLE PIN



SPECIFICATION

Mechanical:

- Termination:** Hand Solder
Dip Solder straight
Dip Solder 90°C
Wire Wrap 0.6 x 0.6mm
- Polarisation:** by trapezoidal shell
- Coupling:** by friction, locking by special accessories
- Withdrawal force:** ca. 0.5 N per contact
- Material and Finishes:** Shell steel with yellow passivation over zinc plate (standard), steel nickel plated and tinned
- Insulators:** Two part mouldings, polyester, glass fibre re-enforced, flame retarded according UL 94 V0
- Contacts:** Gold plated over nickel
- Insertion Cycles:** 500

Electrical:

- Creeping Current Stability:** KB 220 according to DIN 53480
- Working Current:** 5A per contact with 20AWG cable
- Working Voltages:** 300V rms
- Test Voltage:** 1000V rms
- Contact Resistance:** below $5 \times 10^{-3} \Omega$
- Insulation Resistance:** over 10M Ω
- Temperature Range:** -55°C to 125°C

OUTLINE DRAWING

PANEL CUT OUT

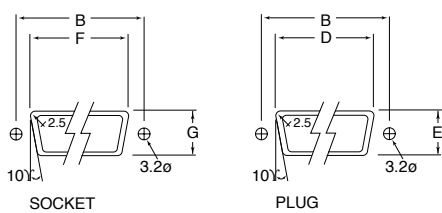

SOCKET

PLUG

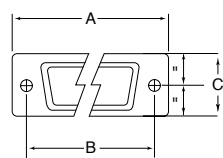

SHELL DIMENSIONS

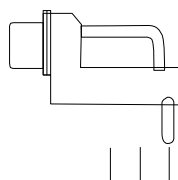

	A	B	C	D	E	F	G
9 WAY	30.8	25.0	12.4	22.2	13.0	20.5	11.4
15 WAY	39.2	33.3	12.4	30.5	13.0	28.8	11.4
25 WAY	53.1	47.0	12.4	44.3	13.0	42.5	11.4
37 WAY	69.5	63.5	12.4	60.7	13.0	59.1	11.4
50 WAY	67	61.1	15.4	58.3	13.0	56.3	14.1

Dimension - mm

ORDERING INFORMATION

DBC

Dubilier Connectors

TD

Series

TD = Turn Pin D

M1

Connector Type

M1 = Male(plug) zinc
F1 = Female(socket) zinc
M2 = Male (Plug) Tin
F2 = Female (Socket) Tin

SR

Contact Style

SR = Solder Right Angled

09

N° of Ways

09 = 9ways
15 = 15ways
25 = 25ways
37 = 37ways
50 = 50ways

3

A

A = Bracket, board and screwlocks

D TYPE CONNECTORS - TURNED PIN

WIRE WRAP

- 9, 15, 25, 37 or 50 way
- Turned Pin (Machined) Contact
- Gold Plated Contacts
- Yellow Zinc Metal or Tin Housings available
- Current Rating - 5Amps

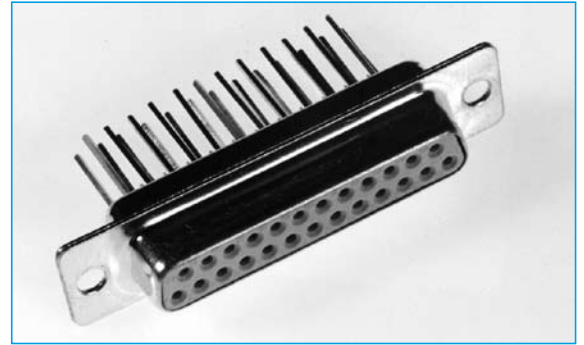

SPECIFICATION

Mechanical:

- Termination:** Hand Solder
Dip Solder straight
Dip Solder 90°C
Wire Wrap 0.6 x 0.6mm
- Polarisation:** by trapezoidal shell
- Coupling:** by friction, locking by special accessories
- Withdrawal force:** ca. 0.5 N per contact
- Material and Finishes:** Shell steel with yellow passivation over zinc plate (standard), steel nickel plated and tinned
- Insulators:** Two part mouldings, polyester, glass fibre re-enforced, flame retarded according UL 94 V0
- Contacts:** Gold plated over nickel
- Insertion Cycles:** 500

Electrical:

- Creeping Current Stability:** KB 220 according to DIN 53480
- Working Current:** 5A per contact with 20AWG cable
- Working Voltages:** 300V rms
- Test Voltage:** 1000V rms
- Contact Resistance:** below $5 \times 10^{-3} \Omega$
- Insulation Resistance:** over 10M Ω
- Temperature Range:** -55°C to 125°C

SECTION 11

OUTLINE DRAWING

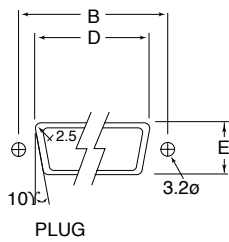
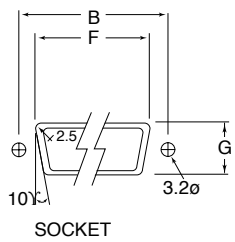

	A	B	C	D	E	F	G
9 WAY	30.8	25.0	12.4	22.2	13.0	20.5	11.4
15 WAY	39.2	33.3	12.4	30.5	13.0	28.8	11.4
25 WAY	53.1	47.0	12.4	44.3	13.0	42.5	11.4
37 WAY	69.5	63.5	12.4	60.7	13.0	59.1	11.4
50 WAY	67	61.1	15.4	58.3	13.0	56.3	14.1

Dimension - mm

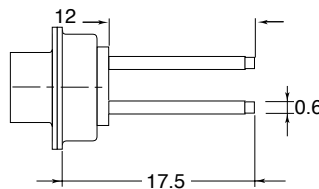
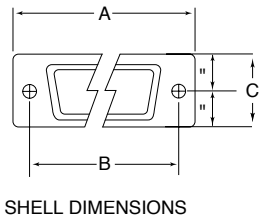

ORDERING INFORMATION

DBC	TD	M1	WW	09	3
Dubilier Connectors	Series	Connector Type	Contact Style	N° of Ways	
	TD = Turn Pin D	M1 = Male(plug) zinc F1 = Female(socket) zinc M2 = Male (plug) Tin F2 = Female (socket) Tin	WW = Wire Wrap	09 = 9ways 15 = 15ways 25 = 25ways 37 = 37ways 50 = 50ways	