

RESISTORS

- Soft copper wire link
- Supplied in reels suitable for all axial insertion machines
- Available in five different wire diameters

WIRE LINK DWL



SPECIFICATION

Material	Soft Copper wire with Tin plating
Conductor Resistance	0.005mΩ/cm
Tension Strength	CNS 8938 28kg/mm ²
Extension Rate	CNS 8938 26°
Conductivity	Minimum 96%
Twisting Strength	CNS 8938 3 cycles
Solderability	JIS520 260°C ± -5°C
95%	
Element of plating	Tin 100%
Plating Thickness	3-5μ
Current Rating at 70°C	0.5mm - 6A 0.6mm - 7.5A 0.7mm - 8.5A 0.8mm - 10A 1.0mm - 15A

OUTLINE DRAWING

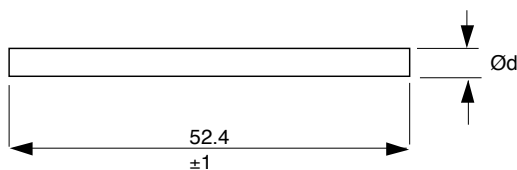

ORDERING INFORMATION

DWL	0.5	/TR
Series	Diameter Ød	Taping
	0.5	
	0.6	
	0.7	
	0.8	
	1.0	